

Straight "L"

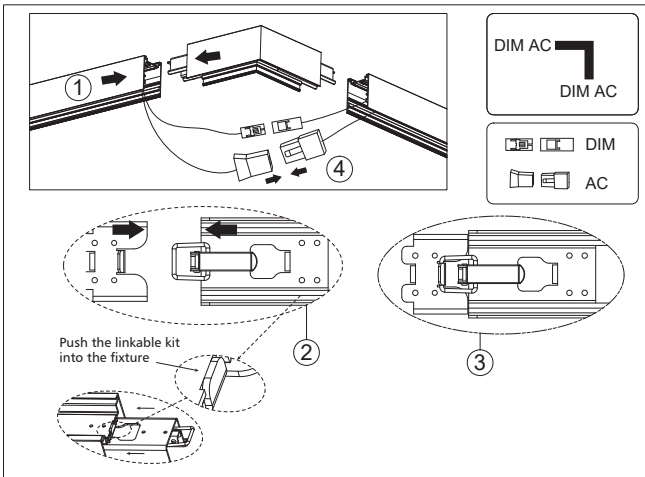

Straight "T"

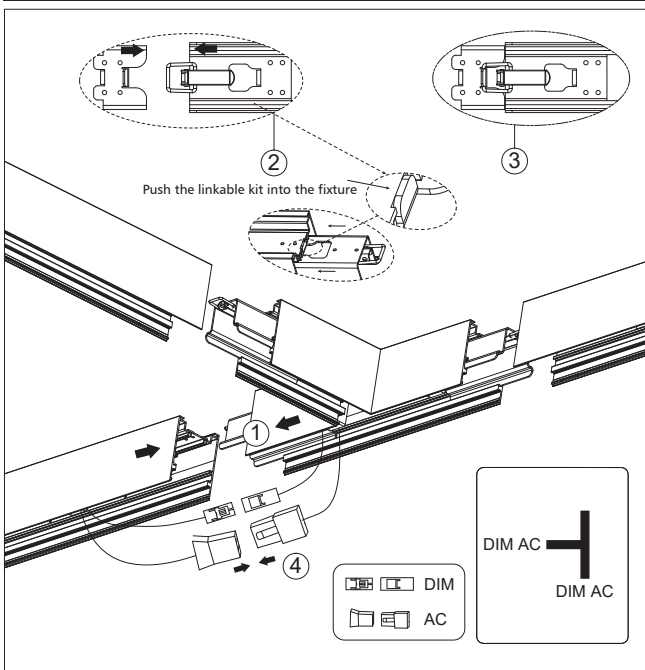

Cover installation

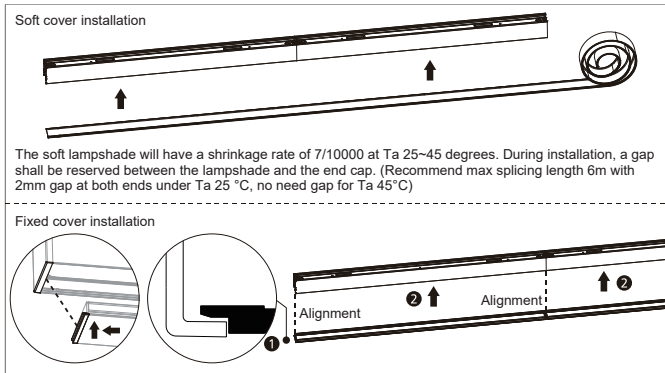

Wiring instruction

LED LINEAR LIGHT USER GUIDE

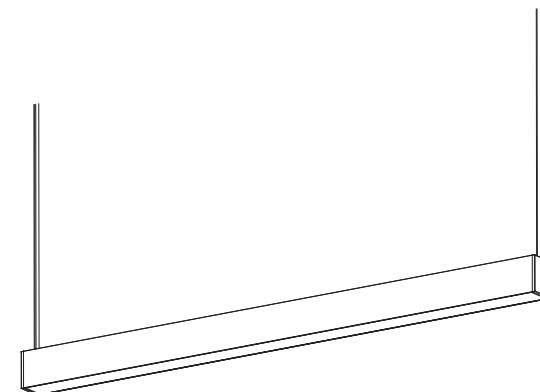

Safety Instructions

To ensure correct function and safety, please read and follow all instructions carefully before using the product:

1. Turn off power before installation or before doing any maintenance work.
2. Do not install any luminaire near the heat source.
3. Do not exceed the nominal supply voltage or amperage ratings.
4. Dimmable version could be compatible with a wide range of recommended TRIAC dimmers.
5. All wiring and installation of the light fitting must adhere to local and national wiring rules.
6. Take care not to pull any electrical wires during unpacking as this may damage the connection.
7. Lay out all the components on a smooth surface and make sure there are no components missing before assembling.
8. To avoid injury or damage to the fitting, please ensure that power leads and screws are secure before connecting the power.
9. Please keep instructions for future reference.

Installation Procedure

WARNING

1. Switch off before installation.
2. Switch on only after complete installation and examination of the circuit.
3. Professional electrician for installation and maintenance only.



Turn Off power supply before starting any installation. Read instructions & check you have all the tools & accessories to complete the installation correctly.

Take out the cover

select preferred colour temperature for product in CCT change function only

COMPLETE
select preferred colour temperature for product in CCT change function only

Push the linkable kit into the fixture

DIM AC

DIM AC

Splicing Qty(Max):	
600-18W: 40PCS	1200-50W: 15PCS
600-25W: 30PCS	2400-72W: 10PCS
1200-36W: 20PCS	2400-100W: 20PCS

Diagram illustrating the assembly of the Linkable Kit into the fixture:

1. Insert the Linkable Kit into the fixture.
2. Push the Linkable Kit into the fixture.
3. The Linkable Kit is fully seated in the fixture.
4. The Linkable Kit is fully seated in the fixture.

Legend:

- DIM
- AC

Connection Diagram:

```

  DIM
  AC
  +
  DIM
  AC
  
```