

ANT-6-4T-BLE-GE

FCC
ETL
DLC
Bluetooth®
Declaration ID: D062134



GEBC
Bluetooth®

12-24V 0-10V DC Plug and Play Bluetooth PIR Sensor

ANT-6-4T-BLE-GE uses PIR motion detector architecture and passive infrared (PIR) technology for improved detection coverage for high bay applications.

It utilizes a Bluetooth® Low Energy (BLE) mesh network. Dimming levels and schedules can be set through GEBC app.

Plug in & play design, low voltage connector, match with audio jack ANT-5-4B-2.

Download on the
App Store



google play



TECHNICAL DATA

Motion Sensor	Passive infrared sensor
Input Power	12-24VDC, >50mA
Control Output	0-10V, max 25mA sinking current
Mounting height	40ft(12m) Max.
Detection angle	360°
Operating temperature	-20°C-60°C
IP rating	65
Max Bluetooth Range	200ft(60m)
Warranty	5years



SENSOR COVERAGE

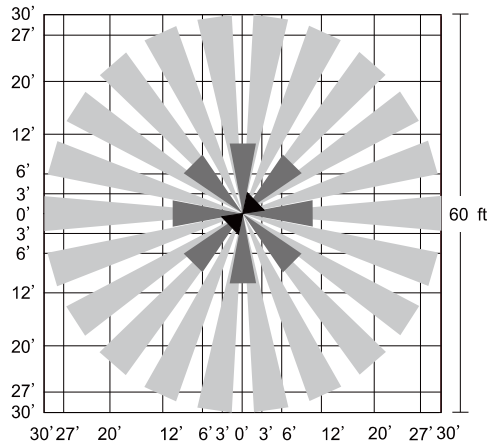
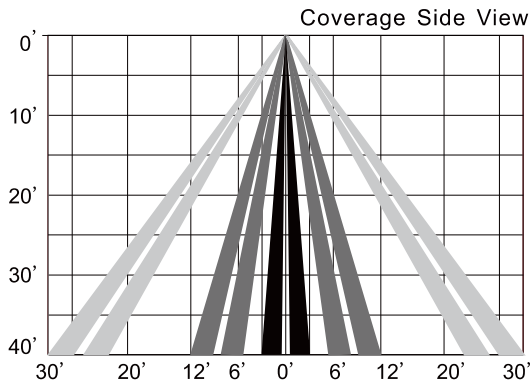

DIMENSIONS AND APPEARANCE

Unit:mm

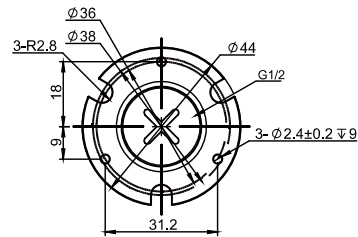
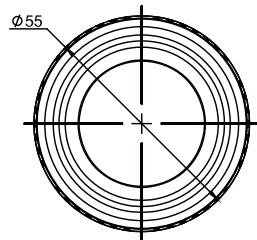
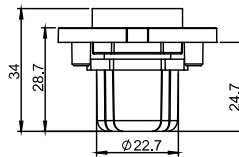
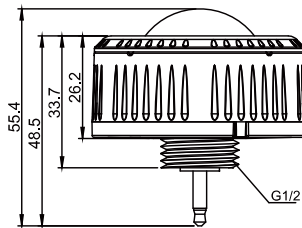

ANT-6-4T-BLE-SR (sensor)

WIRING DIAGRAM

