

CL16

CL16
CYLINDER



CL 16 CYLINDER

DUO Selectable LED Cylinder

CLI6
DUO Selectable LED Cylinder

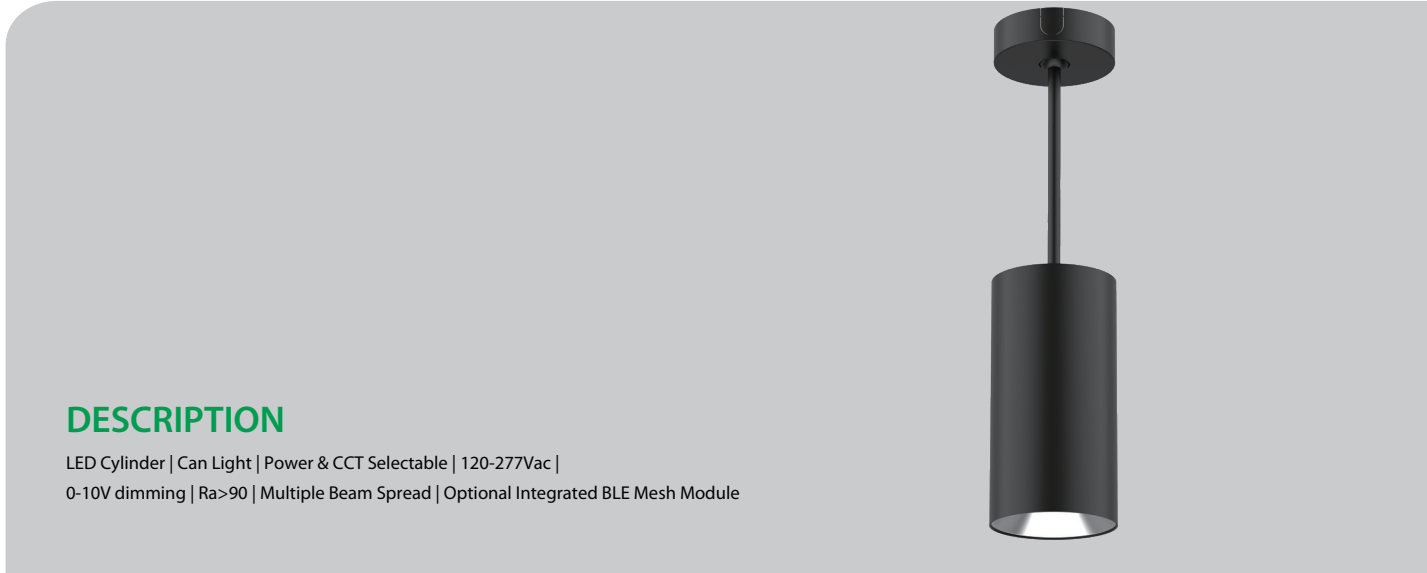

DESCRIPTION

LED Cylinder | Can Light | Power & CCT Selectable | 120-277Vac |
0-10V dimming | Ra>90 | Multiple Beam Spread | Optional Integrated BLE Mesh Module



PRODUCT FEATURES

- Low Profile, Low Glare, Low Flicker, Classic Design
- High Quality Cast Aluminum Housing, Replaces Halogen “Mini-Can” Fixtures
- Power & CCT Selectable
- Multiple Mounting Options (Stem Mount / Cable Mount / Ceiling Mount)
- 40° Beam Spread Refractor Comes Standard (20°, 30°and 50° Refractor Included Separately)
- Ambient Operating Temperature: -10°C(14°F)~40°C(104°F)
- THD<14%, Power Factor>0.9
- ATG Guaranteed 10 Year Warranty
- ETL Listed, Energy Star Listed

* Optional Integrated BLE Mesh Module For Remote Dimming, ON/OFF Via App on PC, Laptop, iPhone, iPad
* L70 Hours>100,000

POWER AND COLOR TEMPERATURE SELECTABILITY

- Feature Color Selectable Technology: Adjust CCT between 3000K / 3500K / 4000K
- Feature Power Selectable Techology: Adjust wattage between 40W / 30W / 20W

APPLICATIONS

Houses of Worship, Schools, Auditoriums, Lobbies, Offices, Museum spaces

PRODUCT SPECIFICATIONS

Model Number	CCT	CRI	3000K			3500K			4000K		
			Wattage(W)	Efficacy(LM/W)	Lumens(LM)	Wattage(W)	Efficacy(LM/W)	Lumens(LM)	Wattage(W)	Efficacy(LM/W)	Lumens(LM)
CLI-40W-T1	3000K/3500K/ 4000K Select	>90	41	102	4,171	41	104	4,258	41	107	4,362
			30	105	3,151	30	107	3,217	30	110	3,296
			20	108	2,164	20	110	2,209	20	113	2,263

CLI6
DUO Selectable LED Cylinder

PHOTOMETRIC SPECIFICATIONS

CLI6A-40W-T1 @4000K 40°

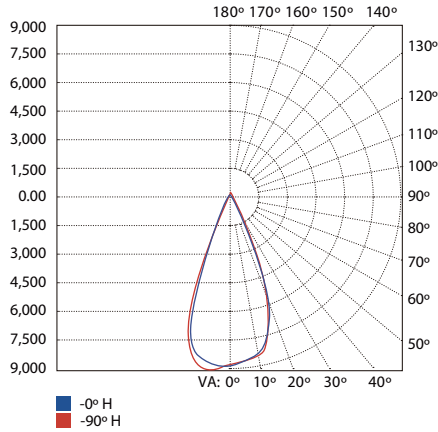

Zonal Lumen Summary

Zone	Lumens	%Lamp	%Luminaire
0-30	3,975.6	91.1%	91.2%
0-40	4,237.4	97.1%	97.2%
0-60	4,358.8	99.9%	100%
60-90	1.7	0%	0%
0-90	4,360.5	100%	100%

ILLUMINANCE AT A DISTANCE

Height (M)	Center Beam	Beam Spread(M)		Field Spread(M)	
	Footcandle	Horizontal	Vertical	Horizontal	Vertical
1.00	8,596.72 LUX	0.8	0.7	1.1	1.1
2.00	2,149.18 LUX	1.6	1.5	2.3	2.2
3.00	955.19 LUX	2.3	2.2	3.4	3.3
4.00	537.30 LUX	3.1	2.9	4.6	4.4

CLI6A-40W-T1 @4000K 50°

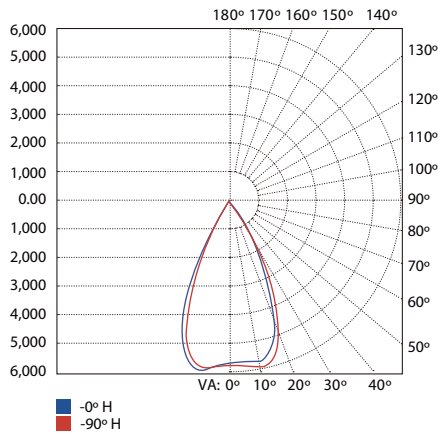

Zonal Lumen Summary

Zone	Lumens	%Lamp	%Luminaire
0-30	3,504.8	81.6%	81.7%
0-40	4,063.0	94.7%	94.7%
0-60	4,289.7	99.9%	100%
60-90	1.8	0%	0%
0-90	4,291.5	100%	100%

ILLUMINANCE AT A DISTANCE

Height (M)	Center Beam	Beam Spread(M)		Field Spread(M)	
	Footcandle	Horizontal	Vertical	Horizontal	Vertical
1.00	5,677.14 LUX	0.9	1.0	1.5	1.5
2.00	1,419.29 LUX	1.8	1.9	2.9	3.1
3.00	630.79 LUX	2.6	2.9	4.4	4.6
4.00	354.82 LUX	3.5	3.8	5.9	6.1

CLI6A-40W-T1 @4000K 70°

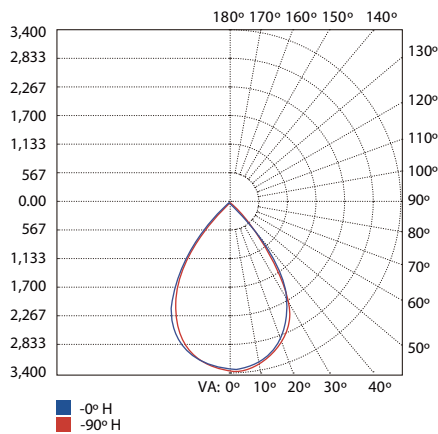

Zonal Lumen Summary

Zone	Lumens	%Lamp	%Luminaire
0-30	2,382.1	61%	61%
0-40	3,463.4	88.6%	88.7%
0-60	3,904.7	99.9%	99.9%
60-90	2.0	0.1%	0.1%
0-90	3,906.7	100%	100%

ILLUMINANCE AT A DISTANCE

Height (M)	Center Beam	Beam Spread(M)		Field Spread(M)	
	Footcandle	Horizontal	Vertical	Horizontal	Vertical
1.00	3,323.43 LUX	1.5	1.4	2.1	2.1
2.00	830.86 LUX	2.9	2.9	4.3	4.3
3.00	369.27 LUX	4.4	4.3	6.4	6.4
4.00	207.71 LUX	5.8	5.8	8.6	8.5

CLI6
DUO Selectable LED Cylinder

PHYSICAL FEATURES

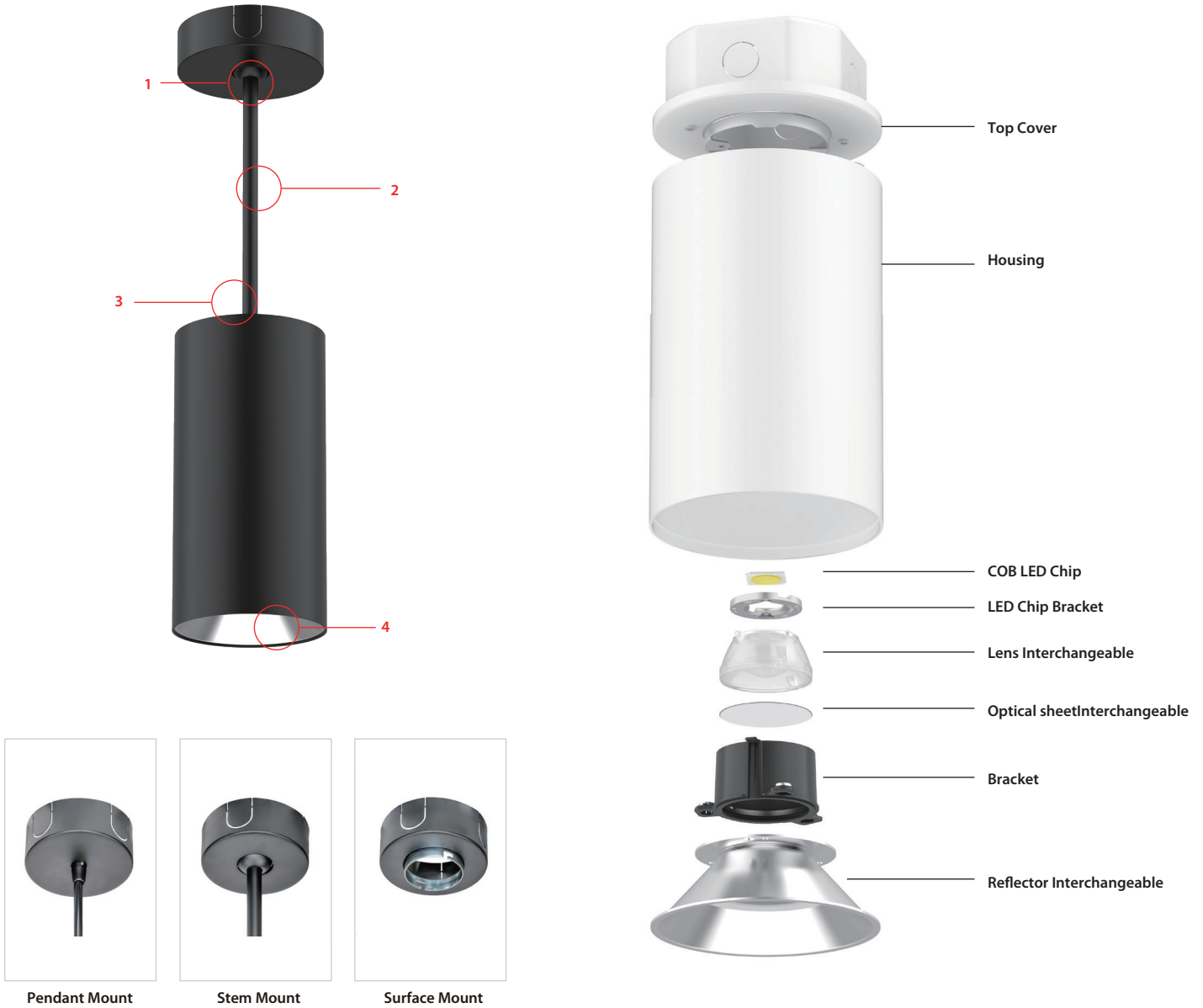

- 1. Stem, ceiling and pendant mount available(Stem mount pictured)
- 2. 12" stem comes standard, 24", 48", 96" stem optional
- 3. Integrated BLE Mesh Control Available For Remote Dimming, On/Off Via App
- 4. Power and CCT Selectable, Multiple Beam Spread Available

CLI6

DUO Selectable LED Cylinder

ADDITIONAL ACCESSORIES (SOLD SEPARATELY)

Model Number	Description
HAC-CLI6-ST	Stem for Stem Mounting, 11.8 inch (30cm)
CAC-CLI6	Extension Power Cable for LED Cylinder, 11.8 inch (30cm)
LEN-CLI6-20D	Lens for LED Cylinder, 20 degree
LEN-CLI6-30D	Lens for LED Cylinder, 30 degree
LEN-CLI6-50D	Lens for LED Cylinder, 50 degree

PRODUCT DIMENSIONS

Pendant Mount (with 1' stem)

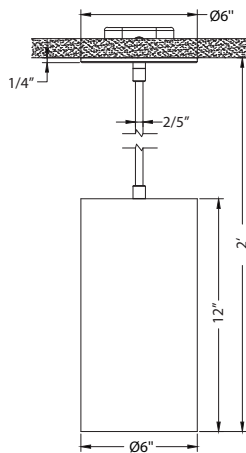

Stem Mount (with 1' stem)

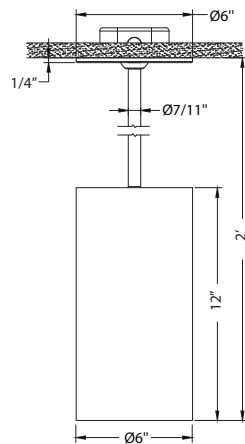

Surface Mount

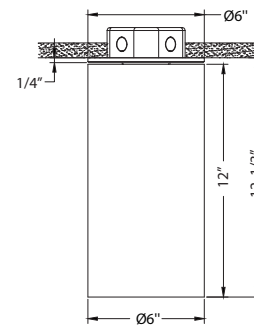

Conduit Pendant Mount (with 1' stem)

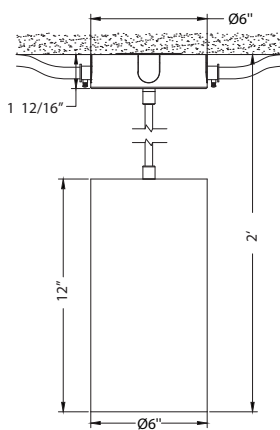

Conduit Stem Mount (with 1' stem)

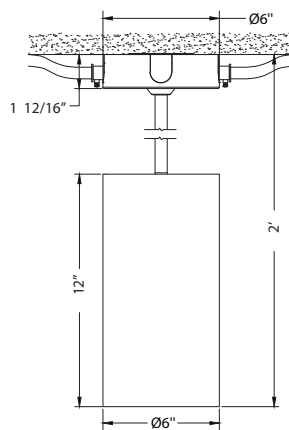

Conduit Surface Mount

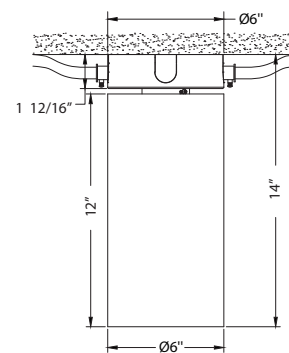

ORDER FORMAT

Series	Wattage	CCT	Control	Finish	Mounting
CLI6	40W	T1			
CLI6	40W= 20W/30W/ 40W Selectable	T1= 3000K/3500K/ 4000K Selectable	Blank= w/o BLU module BL= w/ BLU module	-Blank =Black -W =White	T= Stem Mount C= Ceiling Mount S= Suspension Mount