

Construction Plate

SPECIFICATION

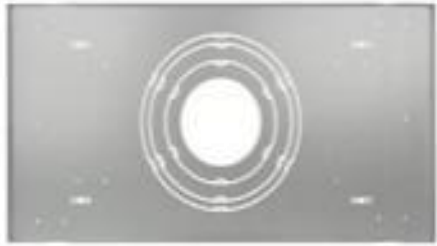

New Construction Plate for Drywall

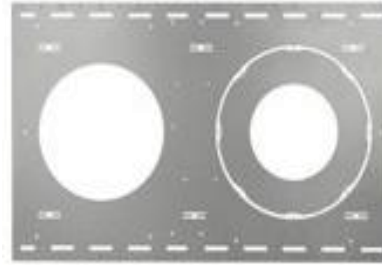

New Construction Plate for T-grid

DESCRIPTION

The construction plate is specifically designed to be used with the Down Light fixture. Works for both new construction joist and T-grid applications.

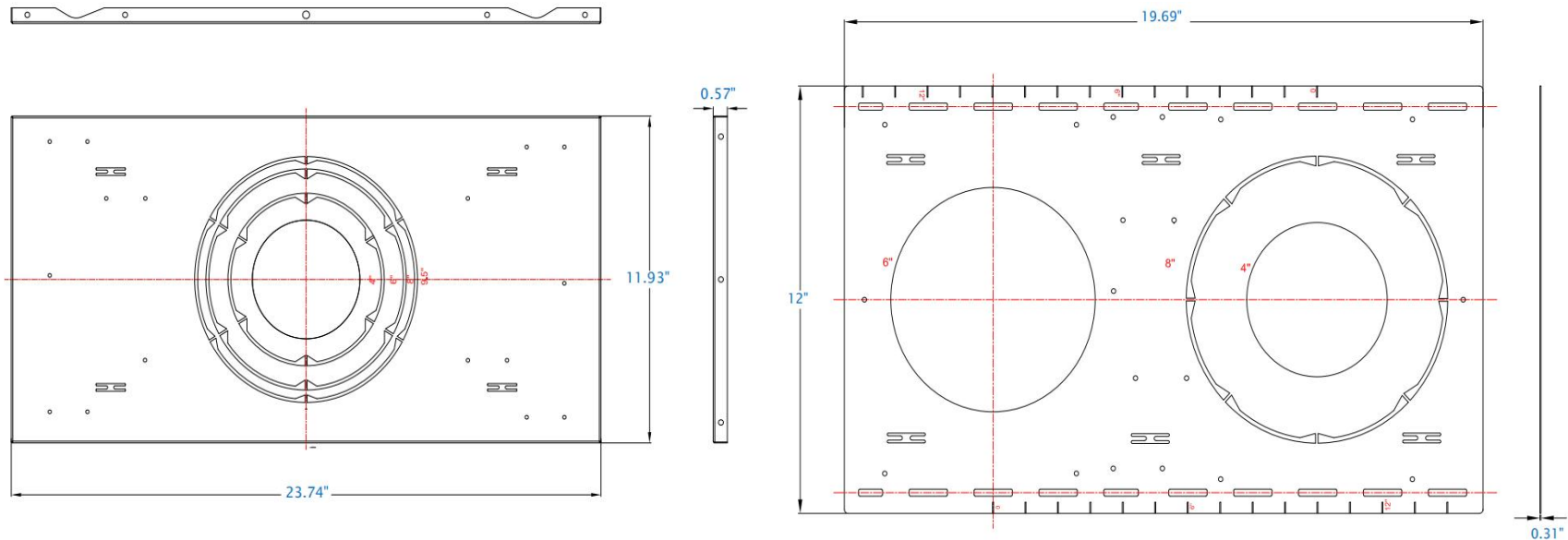

MEASUREMENT

Model	Dimension(inch)		
	Length	Width	Height
A	23.74"	11.93"	0.57"
B	19.69"	12"	0.31"

Installation of J-Box* onto New-Construction

1. Insert bottom tabs of J-box into correct holes of plate.

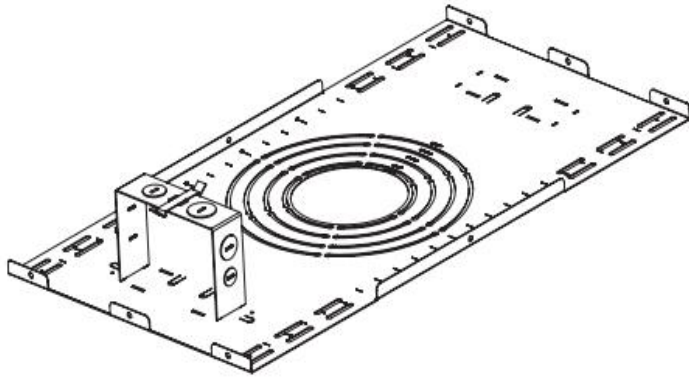

2. Insert side plates into J-box.

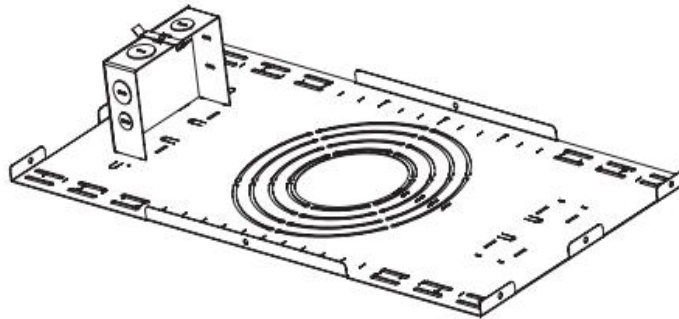

3. Underneath plate, bend J-box tabs with pliers to secure J-box to plate. 4. Installation complete.

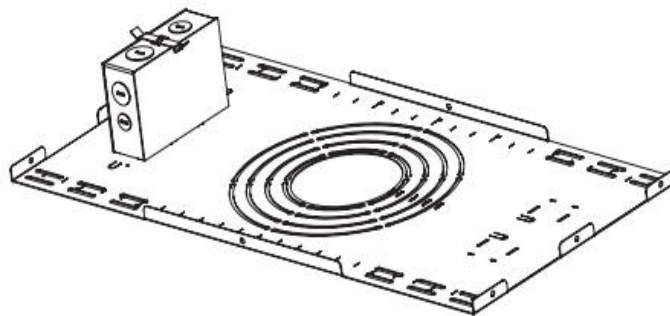
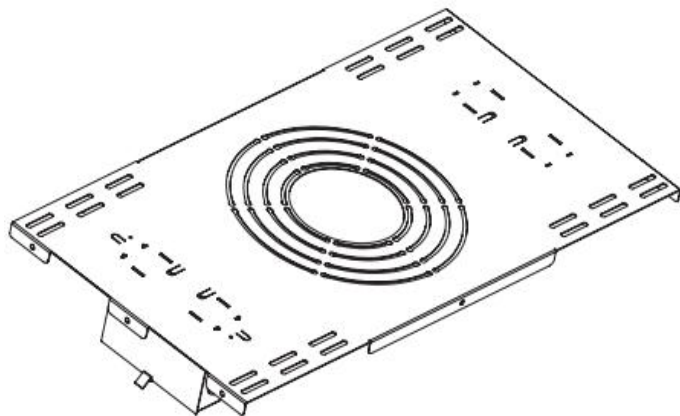

Installation of Plate With Ceiling Joists

1. Align new-construction plate with ceiling joist
2. Secure plate to joists with appropriate screws (not included).

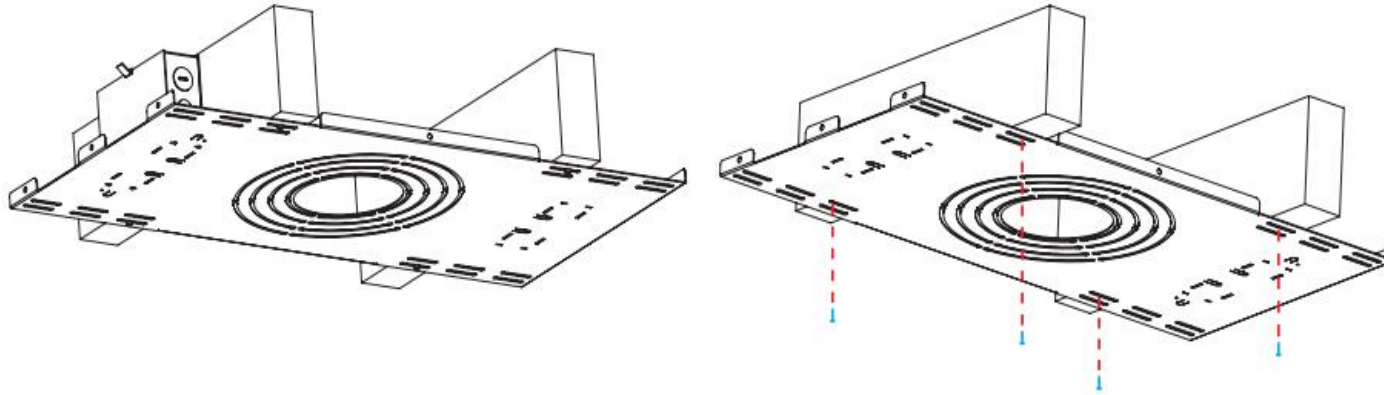

Installation of Plate With Ceiling Joists

1. Lay new-construction plate into T-grid.

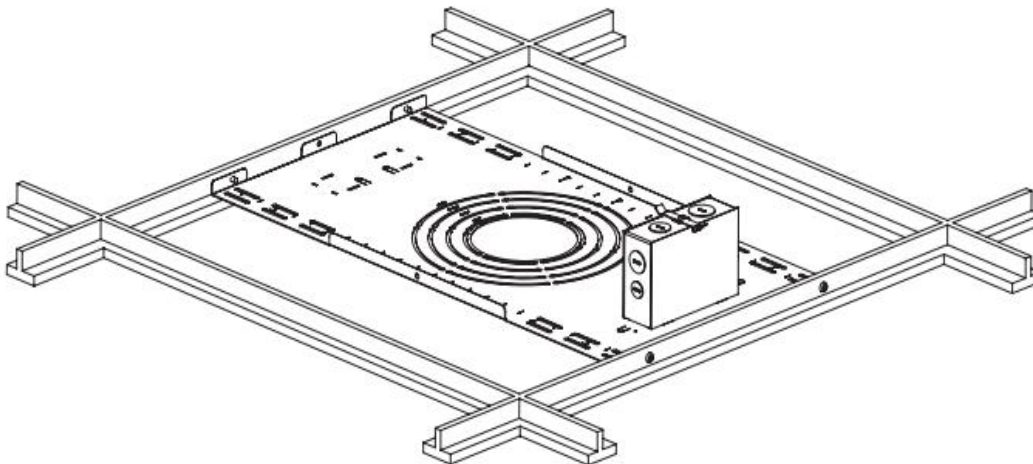

2. Secure plate to T-grid with appropriate screws (not included)

