



iBright™

16W EPS LED Tube

Performance summary

Input: 16W, 100~277VAC, 0.135A

Luminous efficacy: Typ. 100 lm/W

Lumens: 1600lm

CCT: 4000K&5000K

Color Accuracy: CRI 85, R9>20

L70 lifetime: 50,000h

PF>0.95, THD<10%

Performance summary in 2 tubes troffer

Input: 32W, 100~277VAC, 0.27A

Luminous efficacy: Typ. 90 lm/W

Lumens: 2800lm

Spacing Criteria: 0/180: 1.28; 90/270: 1.16



Ordering Information

Typical Order Example: T8ED12L340C016

SERIES	GENERATION	SIZE	VOLTAGE	CCT	Lens Type	OPTION A	OPTION B
T8=T8 Tube	ED=EPS	12=1.2m/4ft	L3=36VDC	40=4000K 50=5000K	C= Clear Lens	0=Default	16=16W

Product Specifications

CONSTRUCTION & MATERIALS	
Dimension	4ft/1.2m
Housing	Extrusion Aluminum and PC diffuser
Finish Color	Silver
Lens Type	Clear

ENVIRONMENTAL SYSTEM	
Work Environment	Indoor use (applicable for dry environments)
Operating Temperature	-20~40°C (-4~104°F)

OPTICAL SYSTEM	
Luminous Flux	1600lm
Luminous Efficacy	100lm/w
Color Temperature	4000K & 5000K
CRI	85
Spacing Criteria	C0/180: 1.28; C90/270: 1.16 in Prismatic Troffer
Lumen maintenance at 6000h	98.28%

ELECTRICAL SYSTEM	
Input Voltage/Current	120VAC~277VAC/0.135A
Off State Power	0W
Power Consumption	16 W
Power Factor	>0.95
THD	<10%



Photometric in Lithonia 2GT8-3-32-A19 Prismatic Troffer

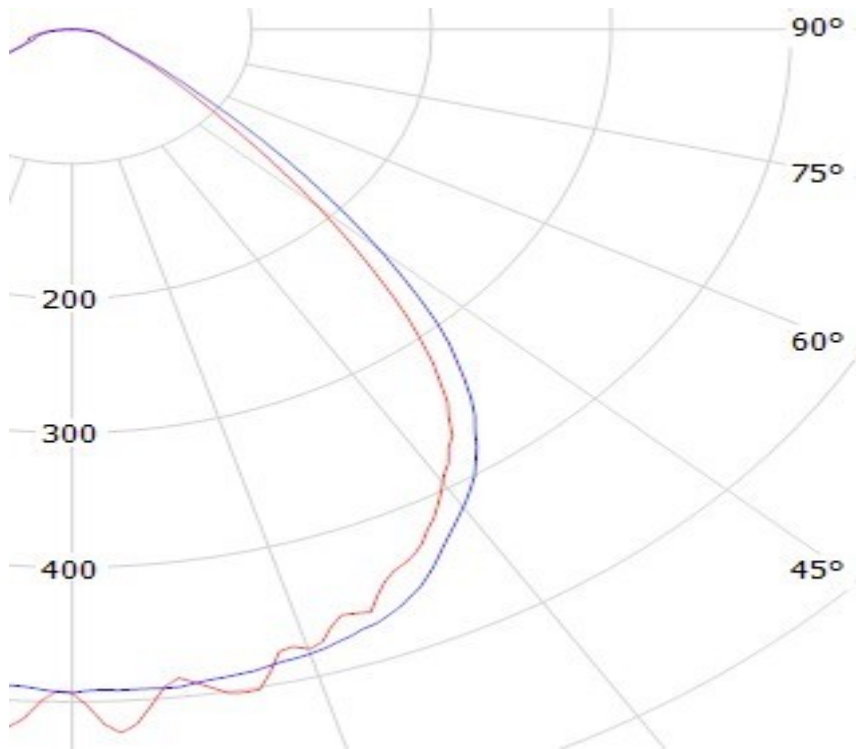

ZONE	LUMENS	% LAMP	% LUMINAIRE
0-30	872.6	31.80%	31.80%
0-40	1,411.70	51.50%	51.50%
0-60	2,318.50	84.60%	84.60%
60-90	421	15.40%	15.40%
70-100	186.5	6.80%	6.80%
90-120	0.9	0%	0%
0-90	2,739.40	99.90%	99.90%
90-180	2.3	0.10%	0.10%
0-180	2,741.70	100%	100%

Photometric in Lithonia 2PM2 2GT8-3-32 Parabolic Troffer

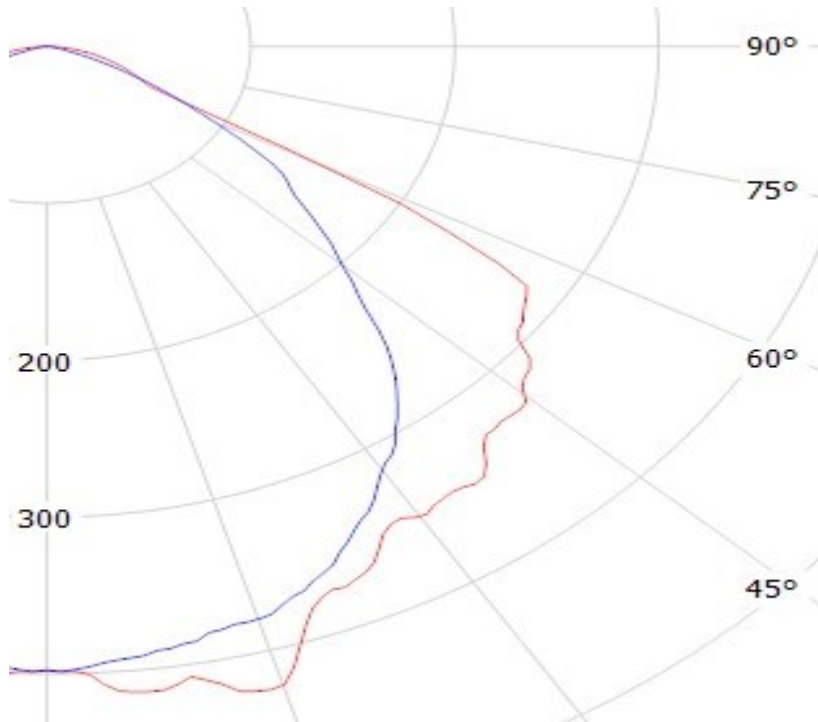

USER GUIDE

Note:

Please read this entire manual to fully understand and safety use this product.

Specifications are subject to change without notice. Please visit www.atgelectronics.com for the most recent user guide versions.

Warning:

WARNING – Risk of fire or electric shock. iBright™ DLC T8 LED Tube installation requires knowledge of luminaires electrical systems. If not qualified, do not attempt installation. Contact a qualified electrician.

WARNING – Risk of fire or electric shock. Install this kit only in the luminaires that have the construction features and dimensions shown in the photographs and/or drawings.

WARNING – To prevent wiring damage or abrasion, do not expose wiring to edges of sheet metal or other sharp objects.

Lamp replacement instructions shall indicate the manufacturer's custom lamp part number, and a method to order replacement lamps by phone, website and/or mail. These instructions shall be included on an information sheet packaged with each unit.

Included in this box

ATG Electronics iBright™ New 16W DLC T8 LED Tube (EPS), 1 Pc

User Guide, 1 set

Accessory Kit, 1 Set, including:

-External Power Supply, 1Pc

-Wire Nuts, 5 Pcs

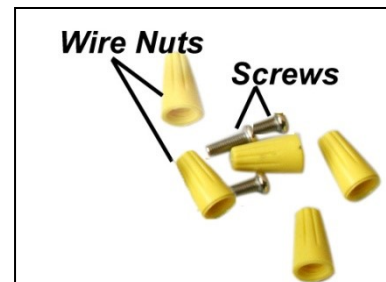

iBright™ DLC T8 LED Tube ONLY work with specific matching external power supplies. Power supplies that do not match specifications will cause the iBright™ DLC to burn out.



● Retrofit Luminaire with Electronic Ballast

Before

Figure 1

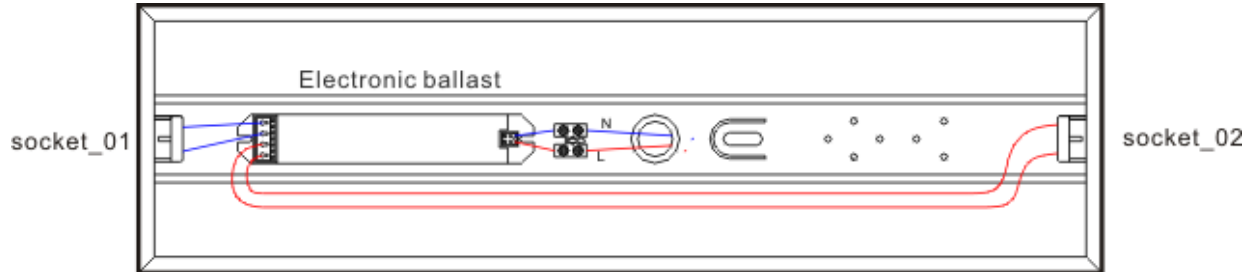

Installation Steps

Step 1: Turn off main power before installation

For safety, make sure main power source is switched off before attempting to install.

Step 2: Remove existing fluorescent light.

The existing fluorescent light is not needed and should be recycled as appropriate.

Step 3: Open the ballast cover, disconnect all power wires from the ballast, and take the ballast out of the fluorescent luminaire, as shown in Figure 2 below.

Keep one wire from each socket to connect to the external power supply. The other wire should be cut off at the socket.

Figure 2

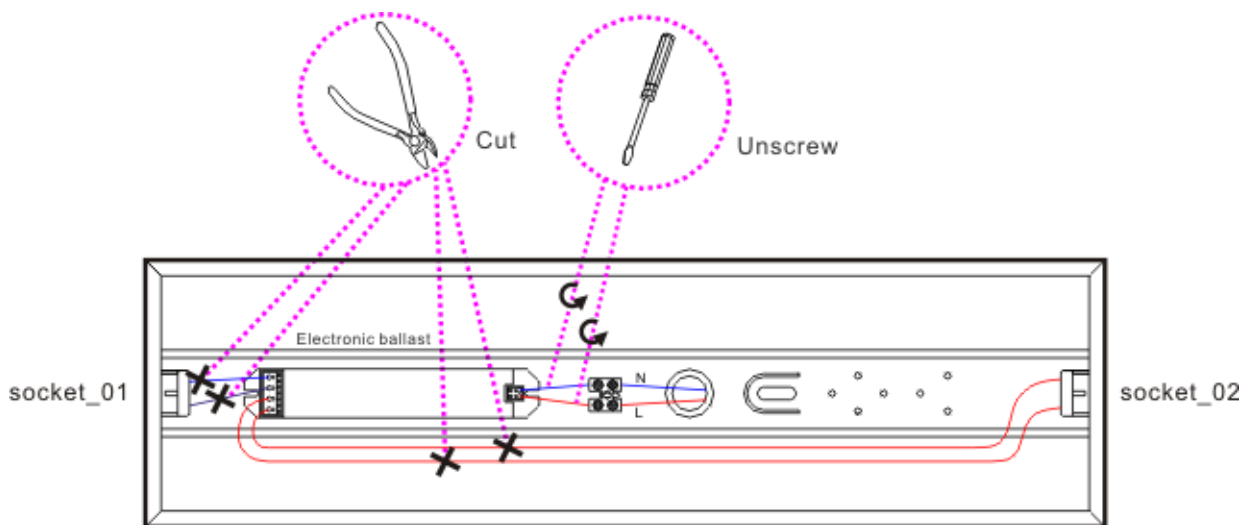

Step 4: Install the MATCHING external power supply, as shown in Figure 3 below.

The external power supply is sized to match the luminaire and should be installed near the middle of the luminaire using the 3M tape and screws provided.

Connect the input wires of the external power supply to the main power outlet.

Using wire nuts, connect the output wires of the external power supply to one wire at both of the T8 sockets.

Place the existing cover back to protect the external power supply.



After

Figure 3

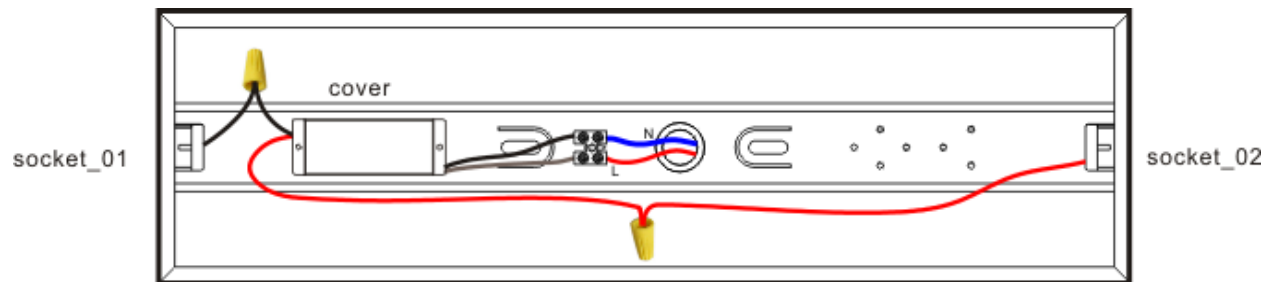

Step 5: Drop the iBright™ DLC into the fluorescent luminaire. Switch main power on to light it up.

● Retrofit Luminaire with Magnetic Ballast

Before

Figure 4

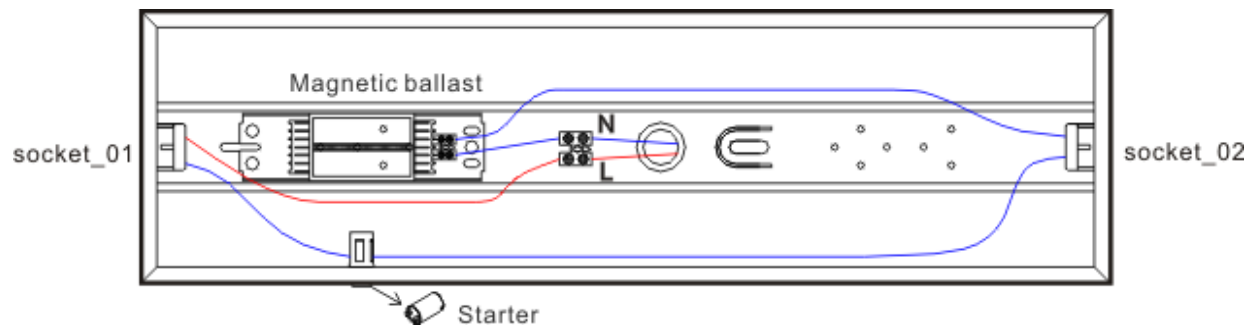

Installation Steps

Step 1: Turn off main power before installation

For safety, make sure the main power source is switched off before attempting to install.

Step 2: Remove existing fluorescent light.

The existing fluorescent light is not needed and should be recycled as appropriate.

Step 3: Open the ballast cover, disconnect all wires from the ballast, and disconnect the starter from the T8 sockets as shown in Figure 5 below. Remove the ballast from the fluorescent luminaire and recycle it as appropriate. Keep the starter in position. Keep one wire from each socket to connect to the external power supply. The other wire should be cut off at the socket.

Figure 5

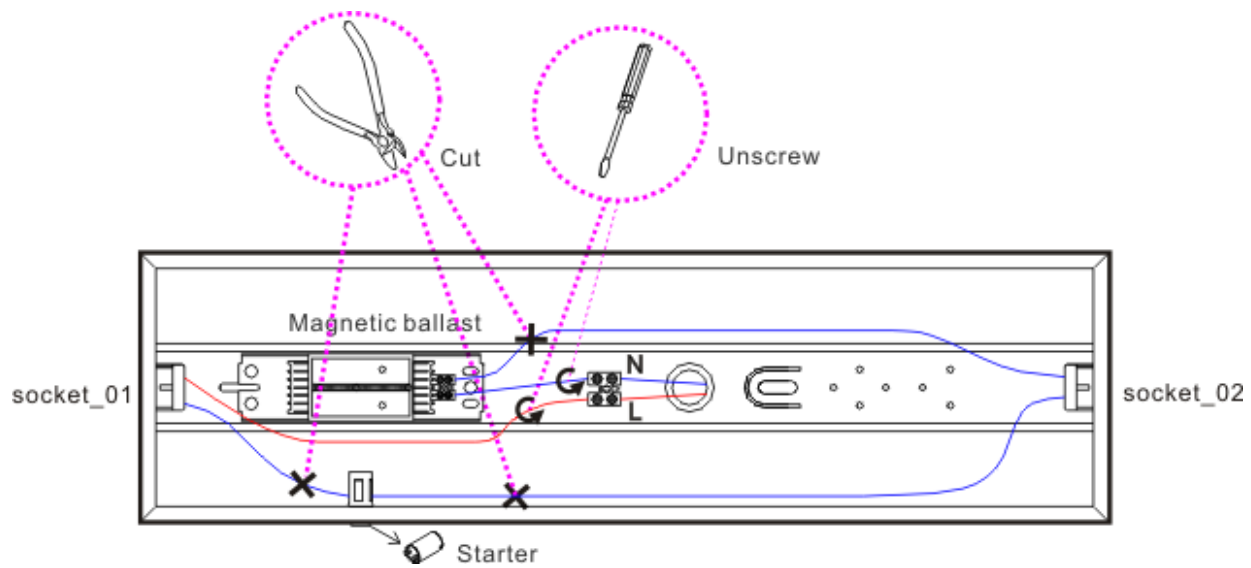

Step 4: Install the MATCHING external power supply as shown in Figure 6 below.

The external power supply is sized to match the luminaire and should be installed near the middle of the luminaire with the 3M tape and screws provided.

Connect the input wires of the external power supply to the main power outlet.

Using wire nuts, connect the output wires of the external power supply to one wire at both T8 sockets.

Place the existing cover back to protect the external power supply.

After

Figure 6

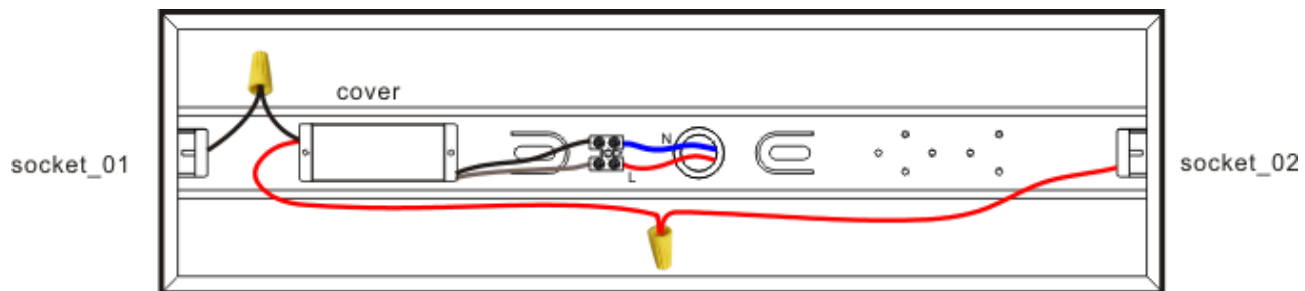

Step 5: Drop the iBright™ DLC into the fluorescent luminaire. Switch main power on to light it up.